

C-995 HANGER FOR C-204 TRACK INSTRUCTION SHEET



PARTS LIST

C-995 HANGER
(2 PER DOOR)



C-995 TOP PLATE
(1 PER HANGER)

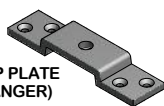

C-995 STUD BOLT
(1 PER HANGER)



3/8" HEX NUT
(1 PER HANGER)



#10 X 1-3/4" FLATHEAD SCREWS
(4 PER HANGER)



EXTRUDED ALUMINUM TRACK



SPECIFICATIONS:
-LOAD CAPACITY:
600 LBS PER DOOR.

-HEAVY DUTY 3/8" DIAMETER BOLT

-HEAVY-DUTY PRECISION BALL BEARING STEEL WHEELS.

-EASY LEVELING AND HEIGHT ADJUSTMENT ACCOMPLISHED BY HAND.

-FOR BY-PASSING, BI-PARTING, POCKET, AND SURFACE MOUNT/BARN STYLE APPLICATIONS.

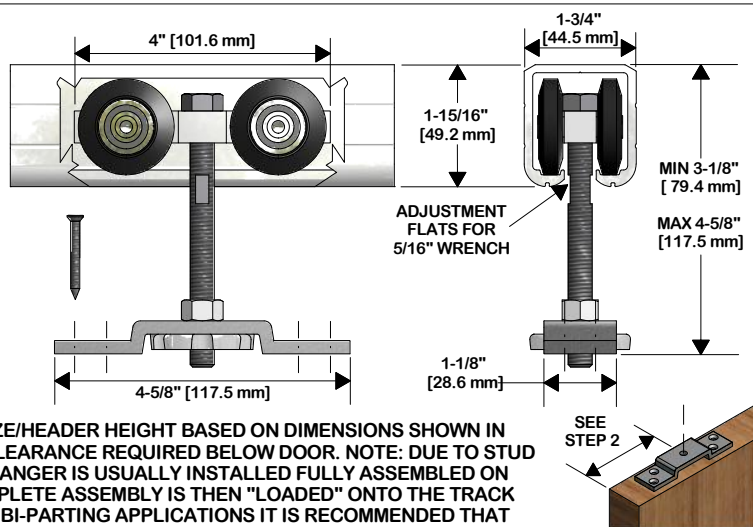

STEP 1

DETERMINE DOOR SIZE/HEADER HEIGHT BASED ON DIMENSIONS SHOWN IN DETAIL VIEWS AND CLEARANCE REQUIRED BELOW DOOR. NOTE: DUE TO STUD LENGTH, THE C-995 HANGER IS USUALLY INSTALLED FULLY ASSEMBLED ON THE DOOR. THE COMPLETE ASSEMBLY IS THEN "LOADED" ONTO THE TRACK FROM ONE END. FOR BI-PARTING APPLICATIONS IT IS RECOMMENDED THAT THE TRACK BE INSTALLED IN TWO PIECES. MOUNT ONE PIECE TO THE HEADER, LOAD BOTH DOORS INTO TRACK, AND THEN INSTALL SECOND LENGTH OF TRACK.

STEP 2

A) LOCATE CLEARANCE HOLE FOR HANGER STUD 5-1/2" FROM EACH EDGE OF DOOR. DRILL WITH 1/2" BIT AT LEAST 2" DEEP. IF USING KNC CAS-2 DOOR STOP, LOCATE CLEARANCE HOLE 5-1/2" FROM EDGE OF DOOR.
B) CENTER TOP PLATE OVER HOLE, MARK SCREW HOLE LOCATIONS AND PRE-DRILL WITH 1/8" BIT AT LEAST 1-1/2" DEEP.

STEP 3

MOUNT TOP PLATE ON DOOR AND SECURE WITH #10 X 1-3/4" FLATHEAD SCREWS (4 PER TOP PLATE). INSERT C-995 STUD BOLT INTO HANGER AND PLACE A 3/8" HEX NUT ON BOLT. INSTALL BOLT THROUGH TOP PLATE AND SPINWHEEL.

STEP 4

PREPARE DOOR FOR INSTALLATION OF OPTIONAL PRODUCTS IF PURCHASED SUCH AS GUIDE CHANNELS, CUP PULLS, DOOR LOCKS, ETC. INDIVIDUAL INSTRUCTIONS ARE PROVIDED WITH THE RESPECTIVE PRODUCT.

STEP 5

LOAD DOOR(S) ONTO TRACK AND SECURE TO HEADER.

STEP 6

ADJUST DOOR HEIGHT AND PLUMB VIA SPINWHEEL WHILE USING A 5/16" WRENCH TO HOLD BOLT FROM ROTATING. LOCK ADJUSTMENT BY TIGHTENING HEX NUT AGAINST TOP PLATE.

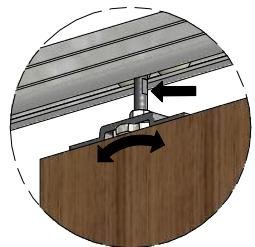
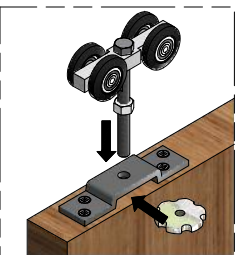
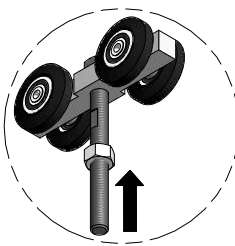

K.N. CROWDER MFG. INC.
1220 BURLOAK DRIVE
BURLINGTON, ONTARIO, CANADA, L7L 6B3
TELEPHONE: 905-315-9788 - FAX: 905-315-8090
TOLL FREE FAX: 1-800-567-0123

K.N. CROWDER INC.
210 EIGHTH STREET SOUTH
LEWISTON, NEW YORK, U.S.A. 14092
TELEPHONE: 1-716-754-8247
TOLL FREE FAX: 1-800-567-0123

WEBSITE: www.kncrowder.com -- E-MAIL: customerservice@kncrowder.com

C-995 HANGER FOR C-204 TRACK INSTRUCTION SHEET



PARTS LIST

C-995 HANGER
(2 PER DOOR)



C-995 TOP PLATE
(1 PER HANGER)

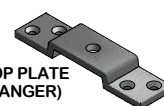

C-995 STUD BOLT
(1 PER HANGER)



3/8" HEX NUT
(1 PER HANGER)



#10 X 1-3/4" FLATHEAD SCREWS
(4 PER HANGER)



EXTRUDED ALUMINUM TRACK



SPECIFICATIONS:
-LOAD CAPACITY:
600 LBS PER DOOR.

-HEAVY DUTY 3/8" DIAMETER BOLT

-HEAVY-DUTY PRECISION BALL BEARING STEEL WHEELS.

-EASY LEVELING AND HEIGHT ADJUSTMENT ACCOMPLISHED BY HAND.

-FOR BY-PASSING, BI-PARTING, POCKET, AND SURFACE MOUNT/BARN STYLE APPLICATIONS.

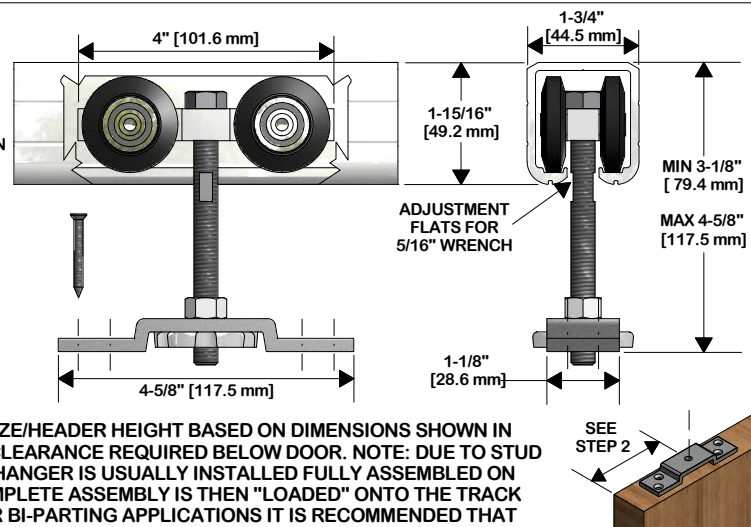

STEP 1

DETERMINE DOOR SIZE/HEADER HEIGHT BASED ON DIMENSIONS SHOWN IN DETAIL VIEWS AND CLEARANCE REQUIRED BELOW DOOR. NOTE: DUE TO STUD LENGTH, THE C-995 HANGER IS USUALLY INSTALLED FULLY ASSEMBLED ON THE DOOR. THE COMPLETE ASSEMBLY IS THEN "LOADED" ONTO THE TRACK FROM ONE END. FOR BI-PARTING APPLICATIONS IT IS RECOMMENDED THAT THE TRACK BE INSTALLED IN TWO PIECES. MOUNT ONE PIECE TO THE HEADER, LOAD BOTH DOORS INTO TRACK, AND THEN INSTALL SECOND LENGTH OF TRACK.

STEP 2

A) LOCATE CLEARANCE HOLE FOR HANGER STUD 5-1/2" FROM EACH EDGE OF DOOR. DRILL WITH 1/2" BIT AT LEAST 2" DEEP. IF USING KNC CAS-2 DOOR STOP, LOCATE CLEARANCE HOLE 5-1/2" FROM EDGE OF DOOR.
B) CENTER TOP PLATE OVER HOLE, MARK SCREW HOLE LOCATIONS AND PRE-DRILL WITH 1/8" BIT AT LEAST 1-1/2" DEEP.

STEP 3

MOUNT TOP PLATE ON DOOR AND SECURE WITH #10 X 1-3/4" FLATHEAD SCREWS (4 PER TOP PLATE). INSERT C-995 STUD BOLT INTO HANGER AND PLACE A 3/8" HEX NUT ON BOLT. INSTALL BOLT THROUGH TOP PLATE AND SPINWHEEL.

STEP 4

PREPARE DOOR FOR INSTALLATION OF OPTIONAL PRODUCTS IF PURCHASED SUCH AS GUIDE CHANNELS, CUP PULLS, DOOR LOCKS, ETC. INDIVIDUAL INSTRUCTIONS ARE PROVIDED WITH THE RESPECTIVE PRODUCT.

STEP 5

LOAD DOOR(S) ONTO TRACK AND SECURE TO HEADER.

STEP 6

ADJUST DOOR HEIGHT AND PLUMB VIA SPINWHEEL WHILE USING A 5/16" WRENCH TO HOLD BOLT FROM ROTATING. LOCK ADJUSTMENT BY TIGHTENING HEX NUT AGAINST TOP PLATE.

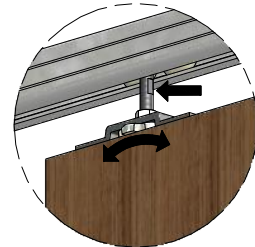
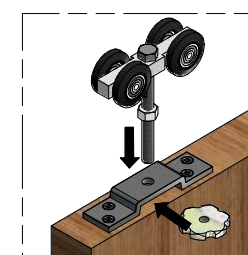
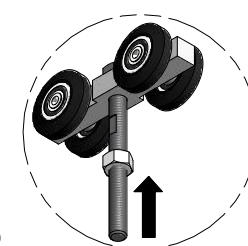

K.N. CROWDER MFG. INC.
1220 BURLOAK DRIVE
BURLINGTON, ONTARIO, CANADA, L7L 6B3
TELEPHONE: 905-315-9788 - FAX: 905-315-8090
TOLL FREE FAX: 1-800-567-0123

K.N. CROWDER INC.
210 EIGHTH STREET SOUTH
LEWISTON, NEW YORK, U.S.A. 14092
TELEPHONE: 1-716-754-8247
TOLL FREE FAX: 1-800-567-0123

WEBSITE: www.kncrowder.com -- E-MAIL: customerservice@kncrowder.com